



News for 09/11/07

The Ultimate 4150 Carburetor

Hi Again,

We are thrilled to announce that we have in development what we believe will be the largest, highest flowing 4150 style carb in production. With 2" throttle bores over a 4150 base and a 4500 air cleaner surface on top, this carb should flow somewhere in the neighborhood of 1450 CFM at 20" of water. That figure is based on the 1698 CFM performance of our 2" bore 4500 series. This light weight, fully profiled beast is intended for applications producing in excess of 900 HP while being restricted to the 4150 style carb. See our [4500 series brochure](#) for the full list of features it will have. SolidWorks images are included below.

John

PS: If anybody has a copy of my 1992 Superflow Presentation on VHS, please contact me.

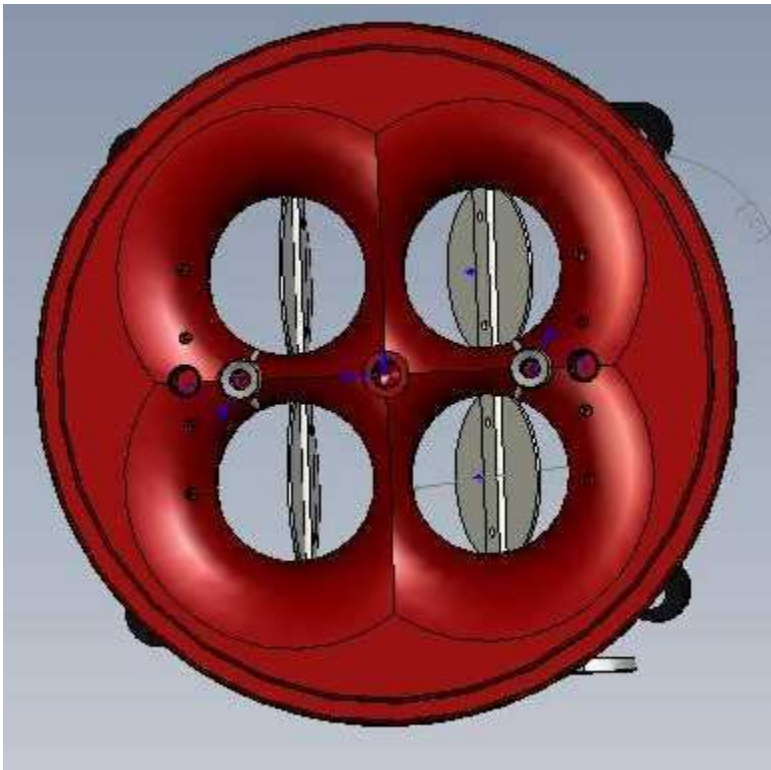
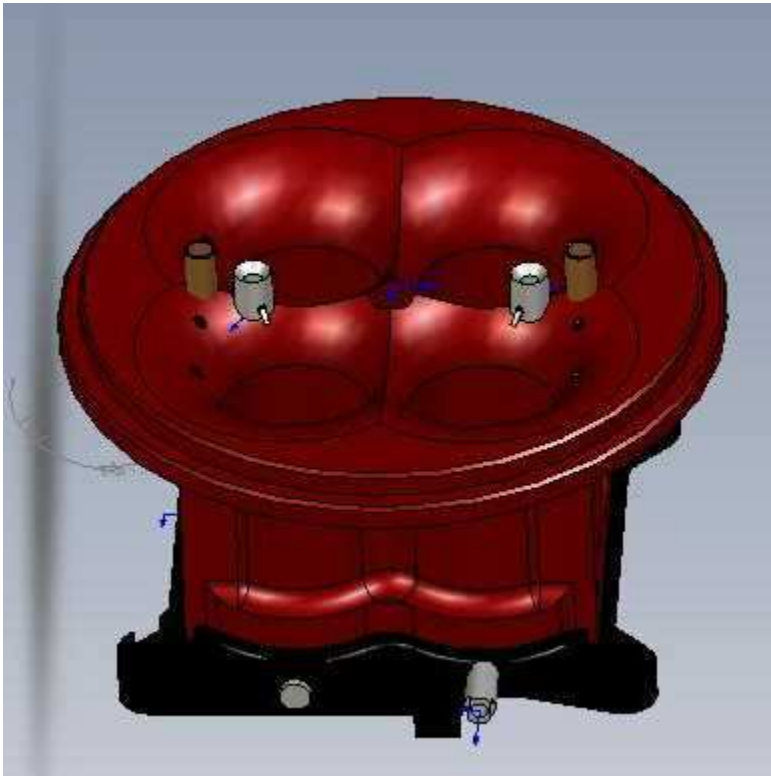

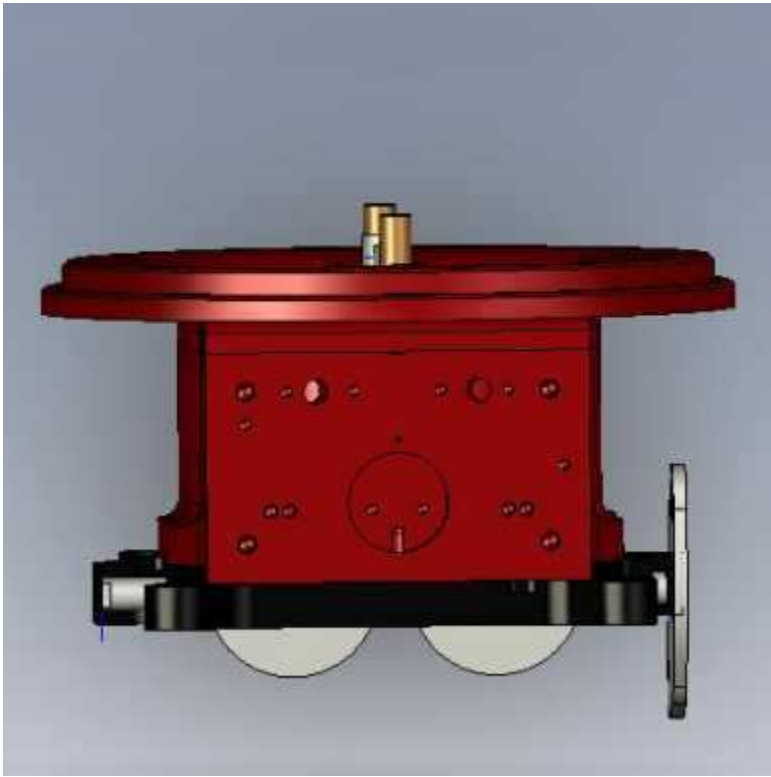

Visit dambest.com.

If you do not wish to receive this News Letter, just reply with REMOVE.