



News for 11/06/07

The Ultimate 4150 Carburetor

Hi Again,

Our Ultimate 4150 has been generating some real interest. This will be the largest, highest flowing 4150 style carb in production. With 2" throttle bores over a 4150 base and a 4500 air cleaner surface on top, this carb should flow somewhere in the neighborhood of 1450 CFM at 20" of water. That figure is based on the 1698 CFM performance of our 2" bore 4500 series. This light weight, fully profiled beast is intended for applications producing in excess of 900 HP while being restricted to the 4150 style carb. See our [4500 series brochure](#) for the full list of features it will have. SolidWorks images are included below.

Our Dyno Operation class is coming up mid January. A dyno can tell you alot, but you have to ask the right questions. Find out about the differences between a dyno engine and a race engine. We're still taking suggestions for dates.

John

PS: If anybody has a copy of my 1992 Superflow Presentation on VHS, please contact me.

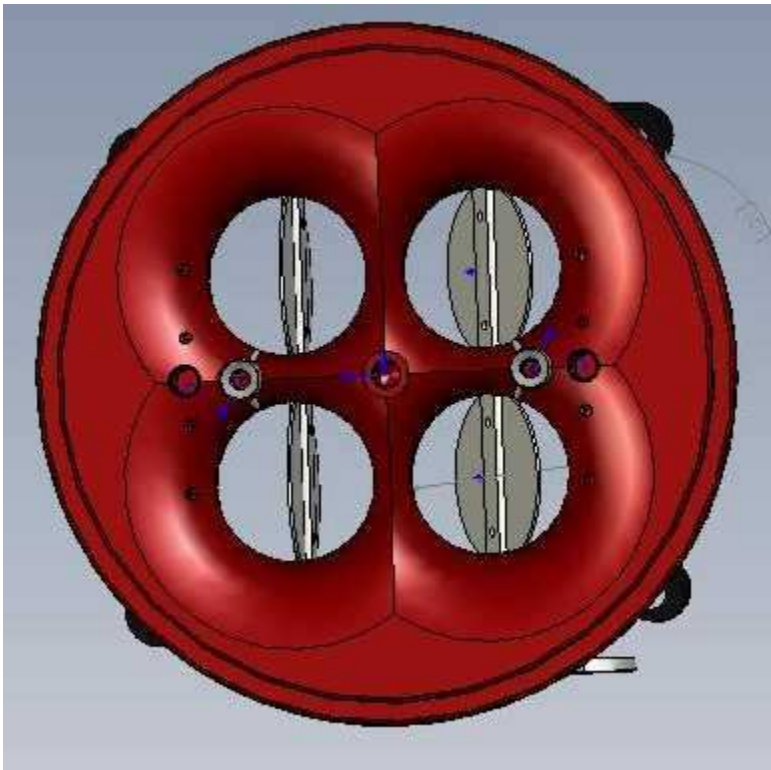
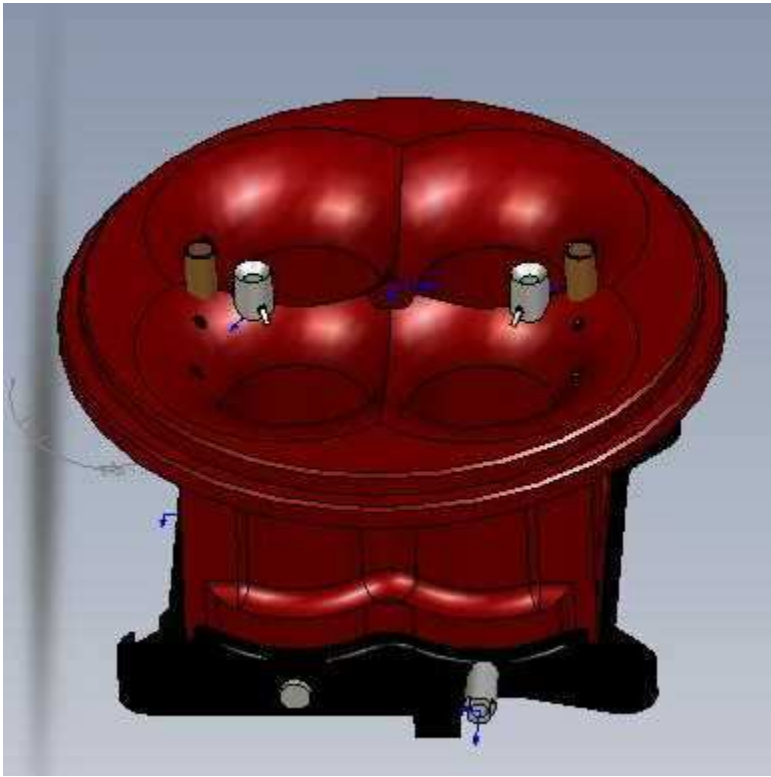



Visit dambest.com.

If you do not wish to receive this News Letter, just reply with REMOVE.